

SPL05.3001.90

Grünzell®

Description

The EYE-LIGHTZ is named for its ability to have several different lens options. It's ideal for lighting not only indoor stairs and hallways, but also outdoor pathways, decks or **step lighting**. With an outside diameter of only 40mm, this product is small and discreet. Featuring a rather clever onboard driver unit, it allows 12 VDC wiring direct in, so wiring is in the standard parallel format.

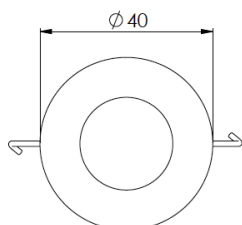
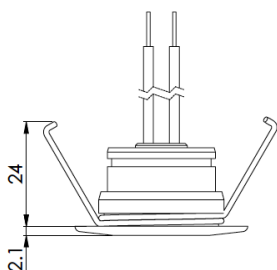

LED Lamp	1
Luminous Flux	100 lm
Colour temperature	3000 K
CRI	80
MacAdam Ellipse	3 Step
Nominal Power	1.6W
Beam Angle	90°

Ingress Protection	IP67
Impact Protection	IK08
Body	Polished Stainless Steel 316 or Satin Black Stainless Steel 316
Weight	-
Line Voltage	100 ~ 270V / 50-60Hz
Electrical Gear	12VDC built in driver